

DTV - 01 Specification

Vehicle-Specific Information

Curbside Expando
45' Long X 13' 6" High X 17' Wide
200 AMP, 208 VOLT SINGLE PHASE
16' Support Trailer

Production

Ross Vision Switcher, 80 Inputs / 48 Outputs, 5ME
Ross Vision Surface 4ME
Ross Vision Surface 2ME
Lance Controller
6 - Quad Multiviewer
2 - 9 X 1 Multiviewer
2 - 9 X 1 Fixed Multiviewer

Communications

RTS Cronus Frames - 60 Ports
17 KP-32 Panels
2 - Dante Beltpacks
4 Line Innkeeper Telephone Interface

Cameras

6 - Hitachi Z-HD5000 Cameras
2 - Large Lens Sled Adapter
2 - Marshall POV
2 - PTZ Cameras
2 - Heavy Hard Camera Tripods
1 - Vinten 700 Pan Head
1 - Vinten 70 Pan Head
2 - Vinten 250 Tripods
2 - Sachtler 18P Tripods

Lenses

2 - Canon 55x with 2X
4 - Hand Held Canon HDGC KJ20x8.5B KRSD PS12 20X

Support Equipment

HD 72X72 Router
2 - Dedicated Streaming PCs
2 - AppleTV (Client Provided Logins)
4 - 32" Monitors (Booth & Field)
40' Jib (DTV Operator Required)

Audio

Yamaha DM 2000 Console
96 Channel
22 Bus
4 - 16X16 Dante Cards
1 - 8 Input Analog Card
1 - 8 Output Analog Card
1 - Spot On Music Replay System

Microphones

4 - Shure Announcer Headsets
4 - Studio Technologies Announcer Cough Boxes (Dante)
4 - Shure Axient Digital Hand Held Microphones
1 - Shure Axient AD600 Digital Spectrum Manager
1 - Shure Axient AD610 Diversity ShowLink Access Point
6 - Sennheiser 816 Shotgun Microphones
3 - Sennheiser MD46 Stick Microphones
2 - DPA 4288 Cardioid Headset Microphone (dark tone)
4 - DPA 4288 Cardioid Headset Microphone (light tone)
2 - DPA 4080 Cardioid Lavalier Microphones

Record and Playback

2 - 8X2 vMix Replay Machines
5 - HyperDeck Studio Pro Recorders
1 - HyperDeck Studio Pro Dedicated as SpotBox

Graphics

1 - Chyron HyperX3 - Dual Channel System

Cabling and Support

6 - Multidyne HUT Systems
4 - 15 Meter SMPTE
4 - 30 Meter SMPTE
4 - 150 Meter SMPTE
4 - 450 Meter TAC-12 ST Single Mode Fiber
2 - 230 Meter TAC-12 ST Single Mode Fiber
5 - 100 Meter TAC-12 ST Single Mode Fiber
1 - 5' 400 AMP Feeder Tails
1 - 50' 400 AMP Feeder
1 - 100' 400 AMP Feeder

DIAKON TV

PO Box 56783 Jacksonville, FL 32258
904-584-7500 www.diakontv.com

DTV - 01

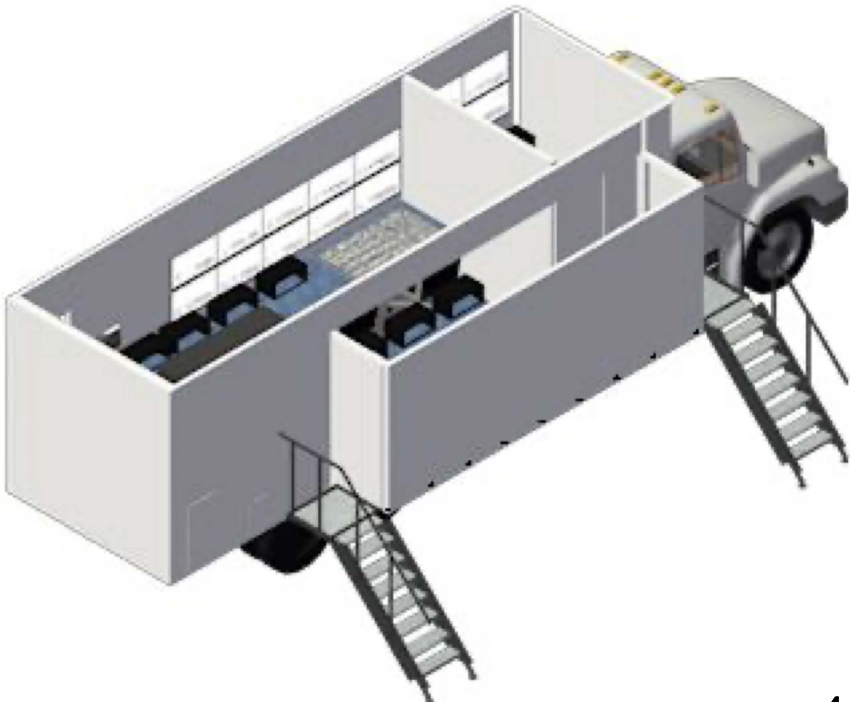

42'-0"



DTV - 01

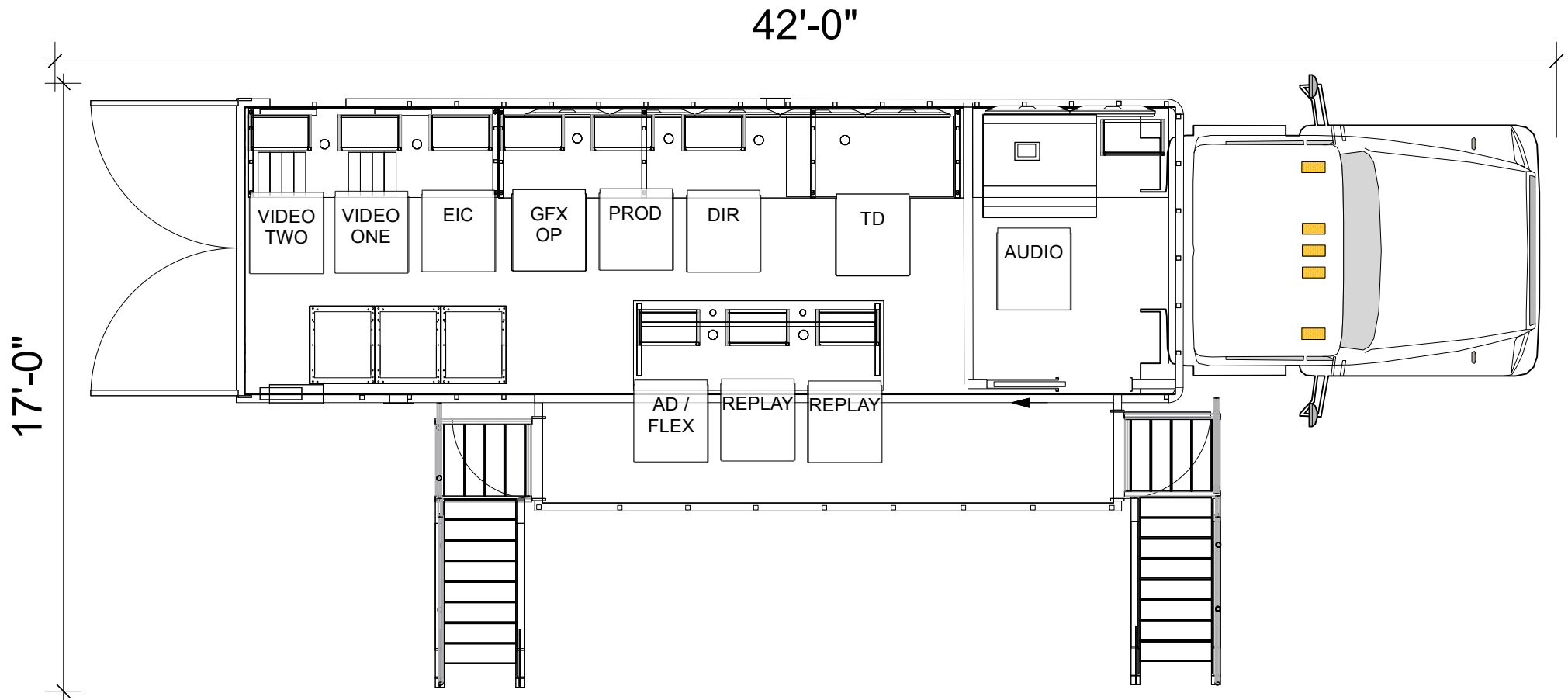

DIAKON TV

PO Box 56783 Jacksonville, FL 32258
904-584-7500 www.diakontv.com

Monitor Walls

